

**3x10mm**

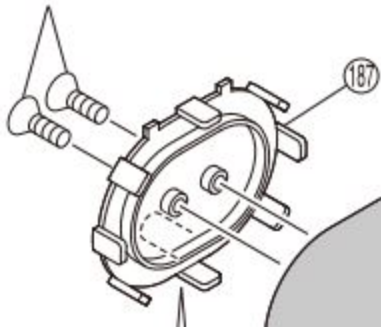

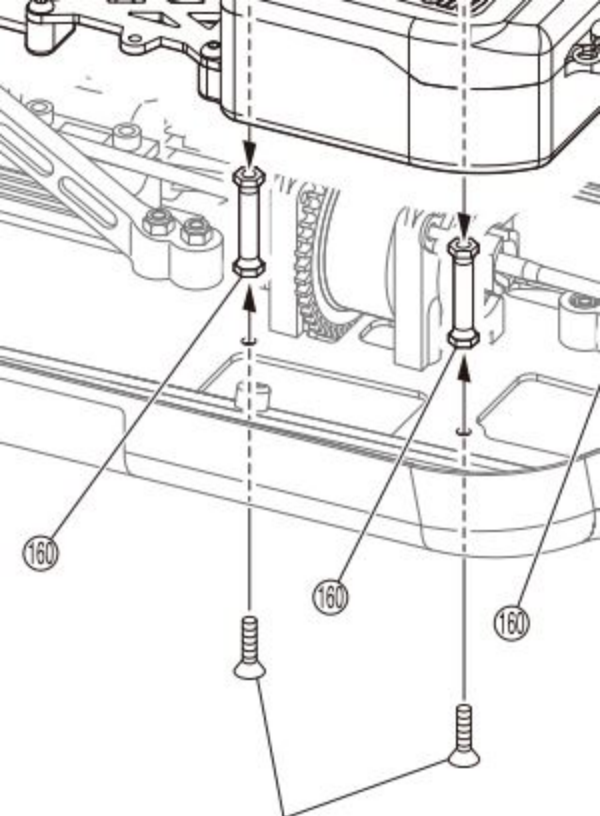

**3x10mm**

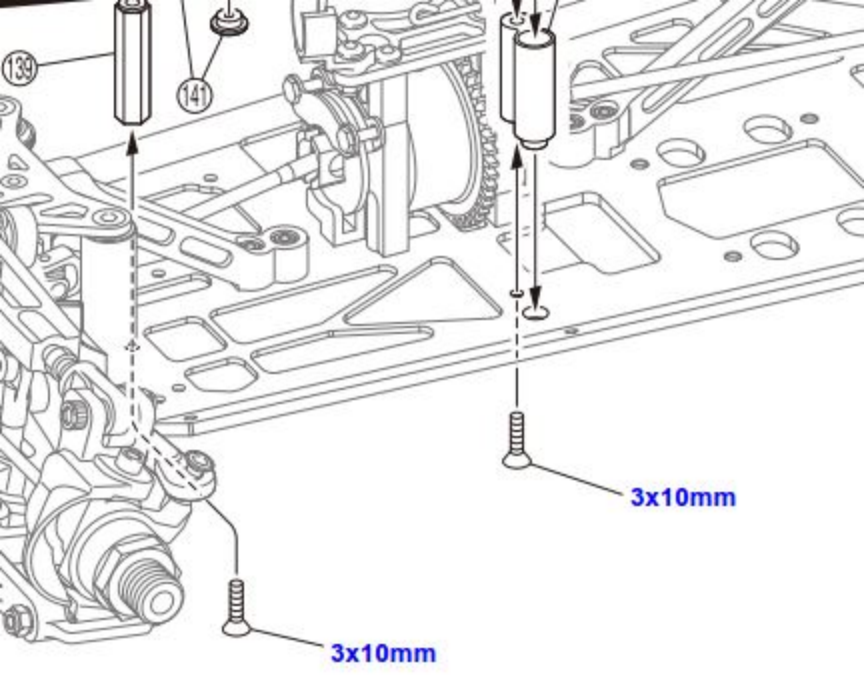

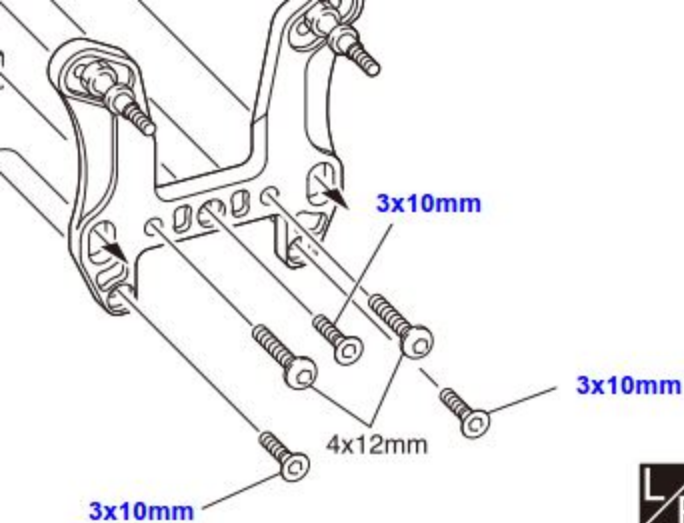

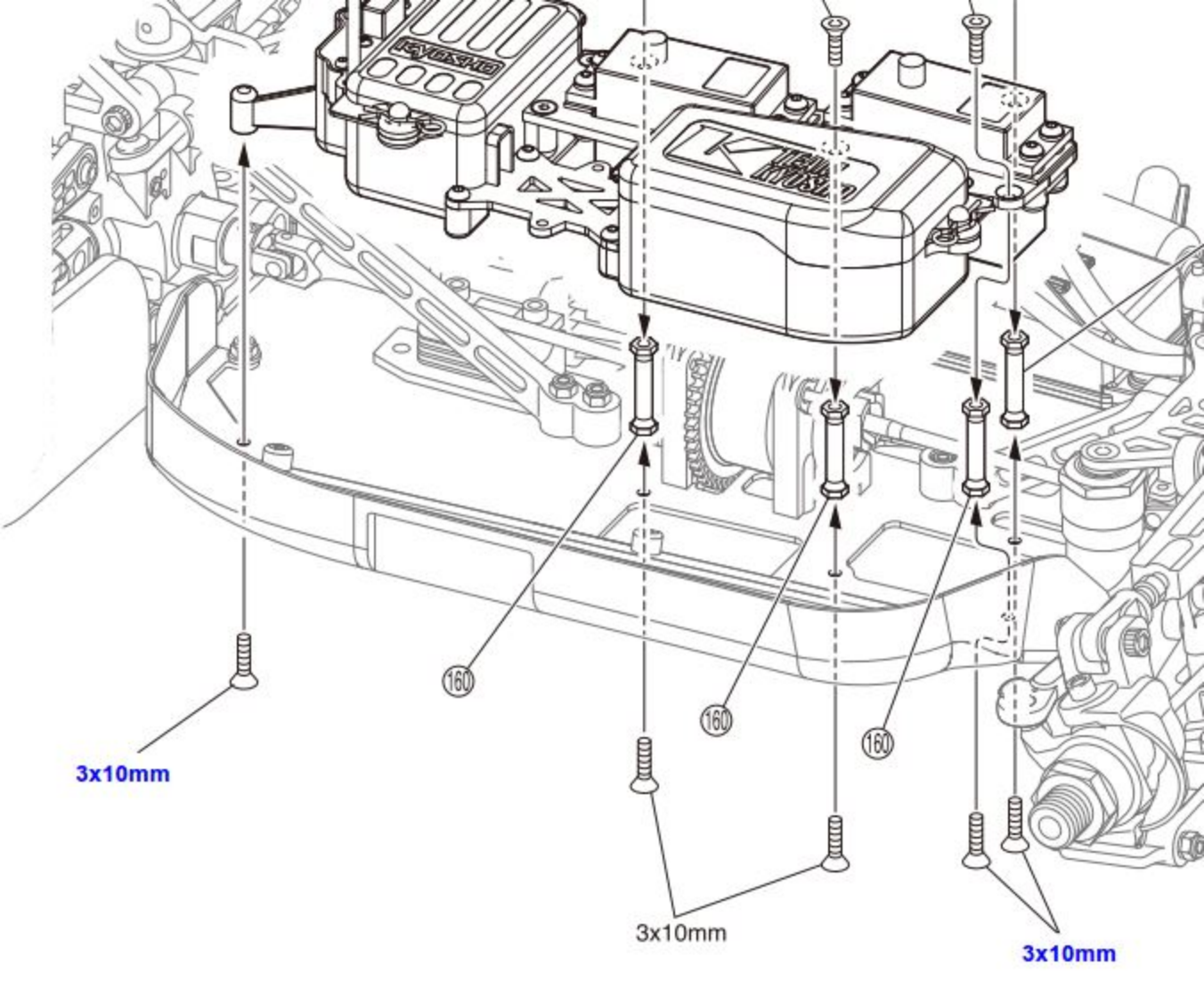



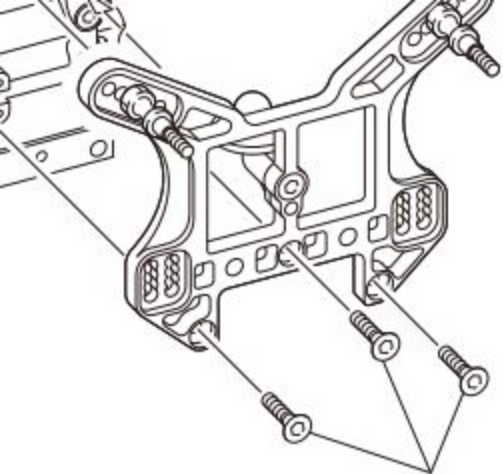

**3x10mm**

3x10mm

3x10mm

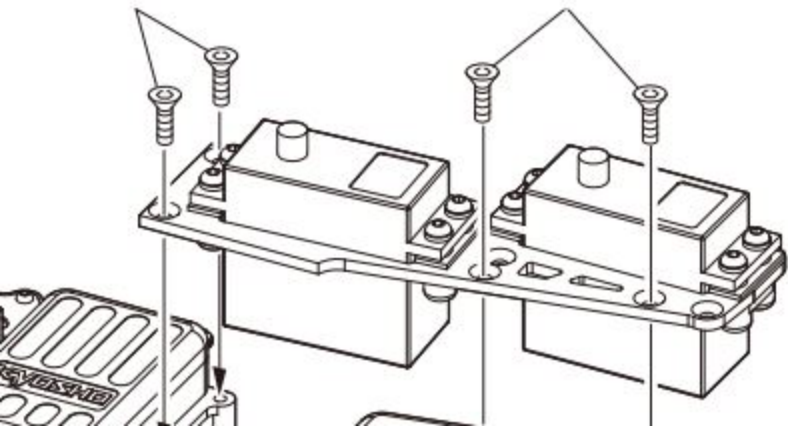

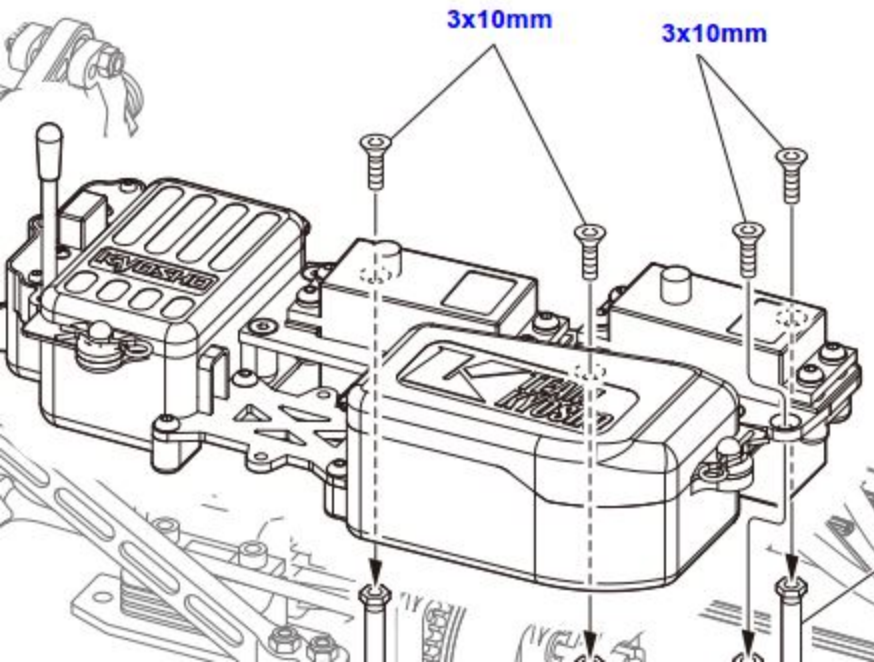

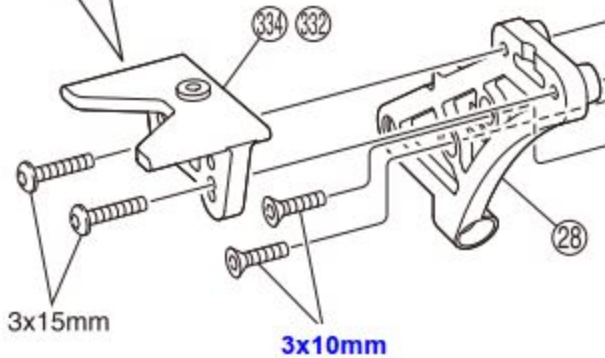

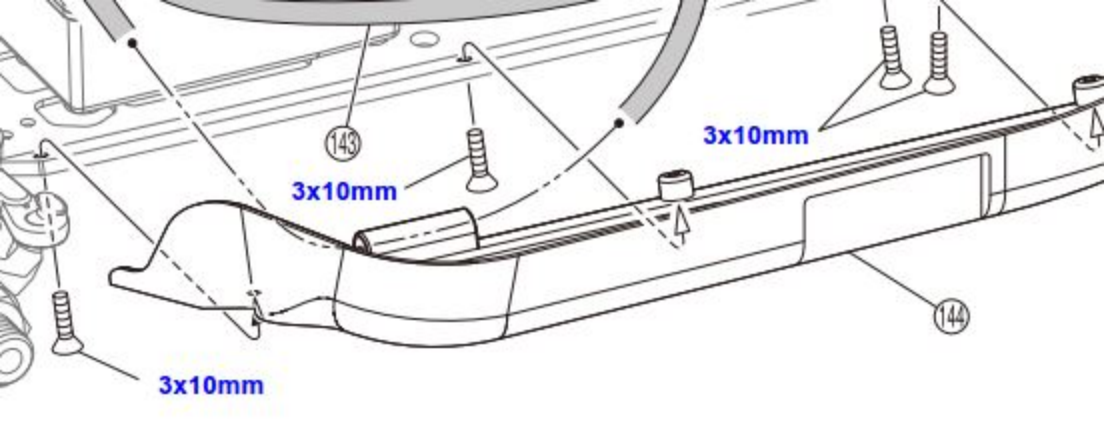

143

3x10mm

3x10mm

3x10mm

144

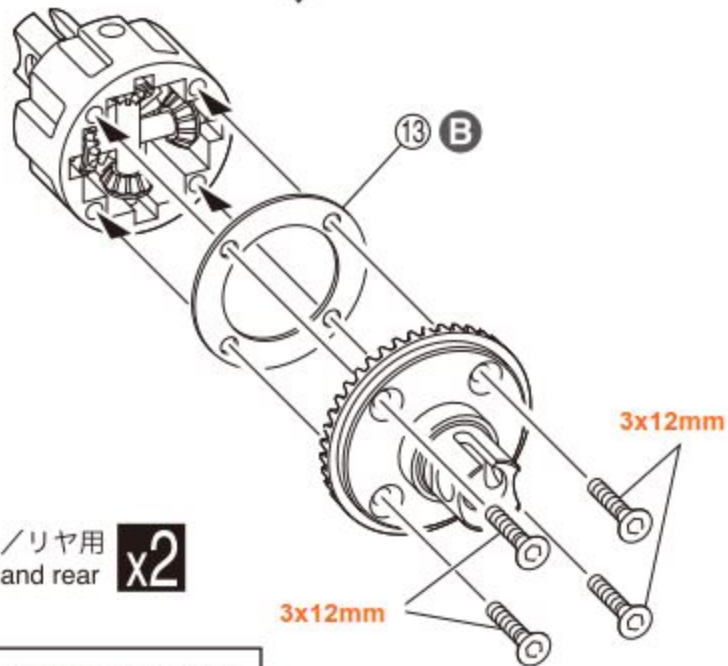

フロント/リア用  
front and rear **x2**

3x12mm

3x12mm

8 x 16 x 5mm ベアリング  
Ball Bearing

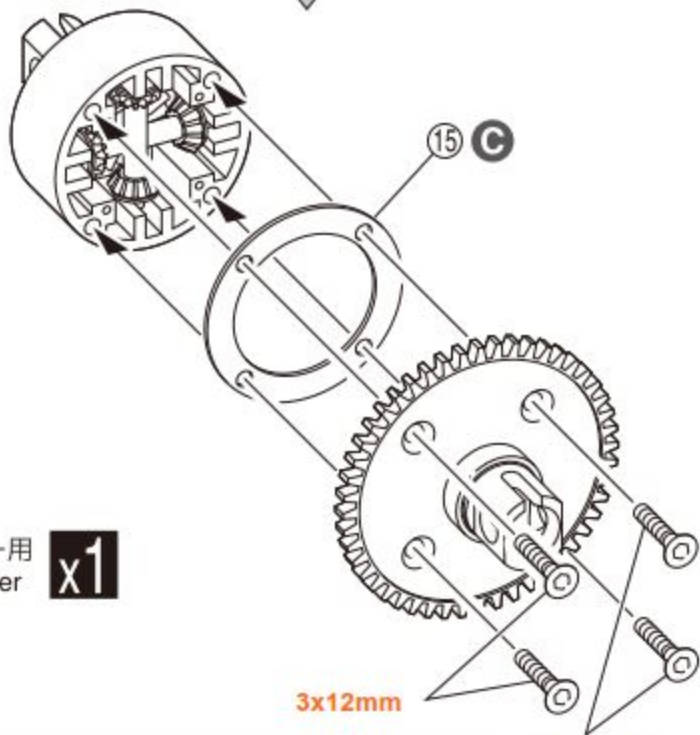

センター用  
For center **x1**

3x12mm

3x12mm

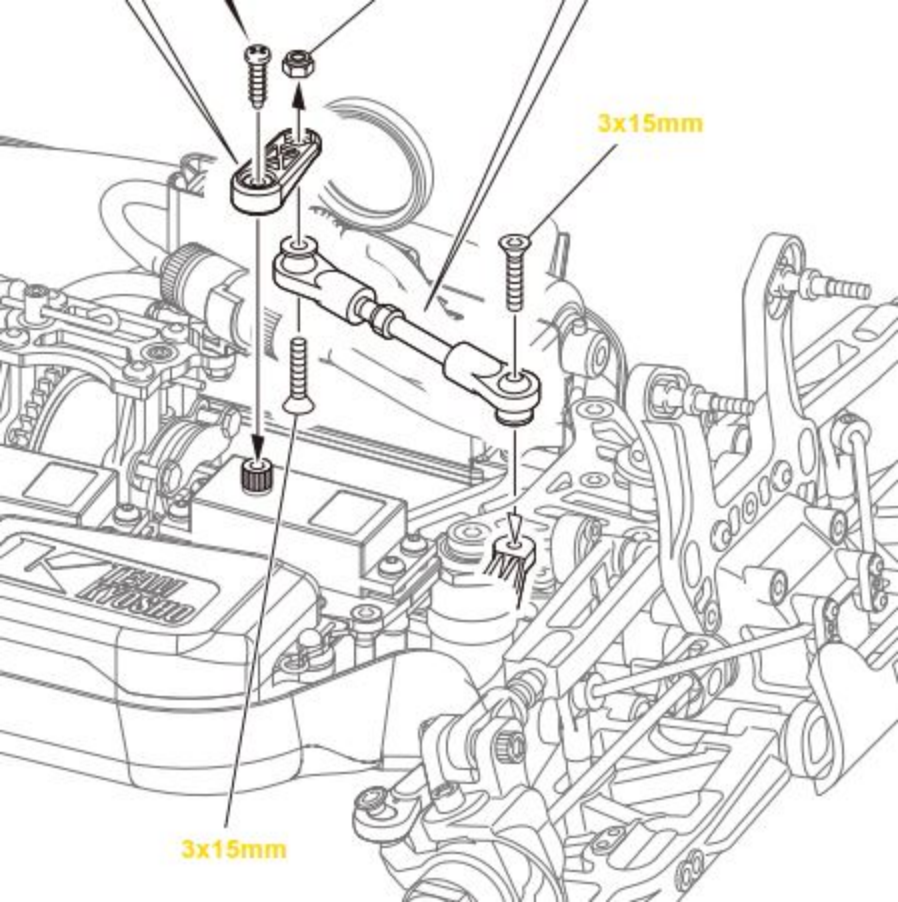

3x15mm

3x15mm

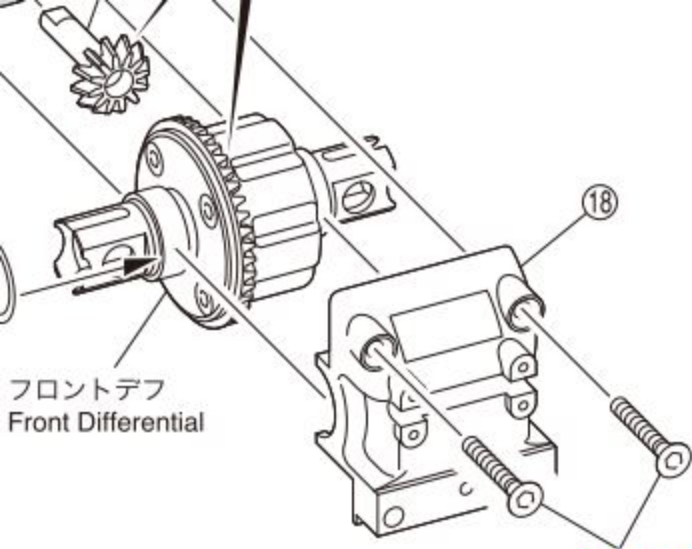

フロントデフ  
Front Differential

18

3x18mm



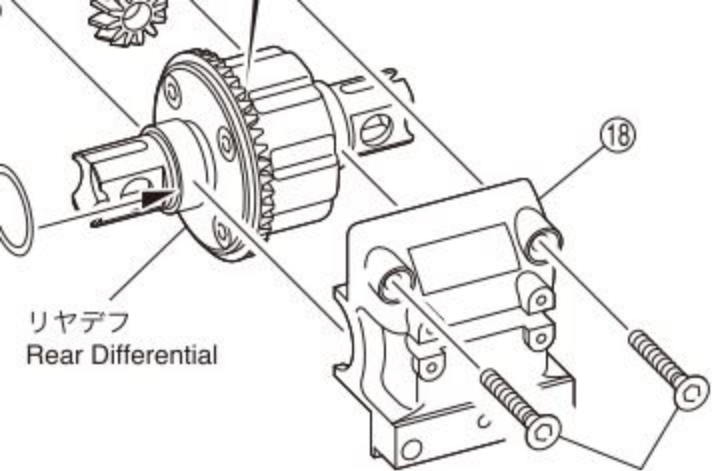

リヤデフ  
Rear Differential

18

3x18mm

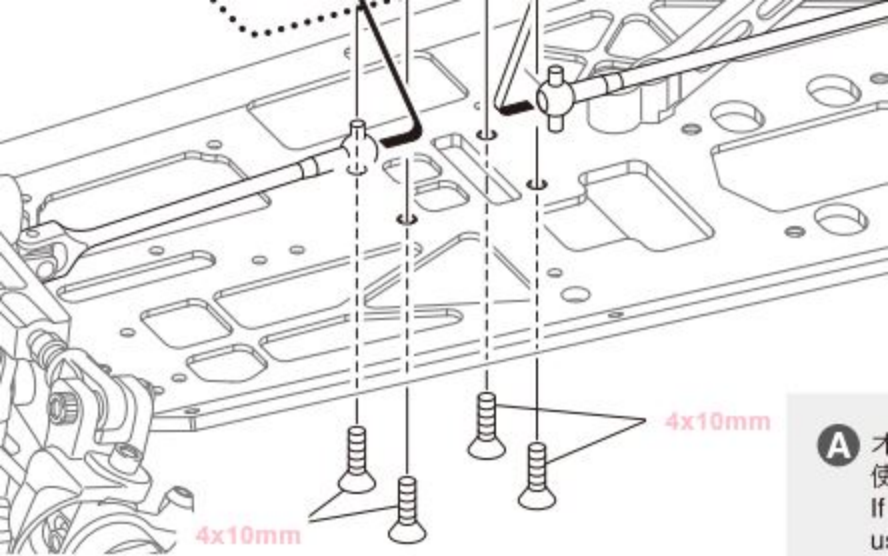

**A**

才  
使  
If  
u

4x10mm



114



A

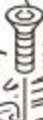

3x12mm

B

C

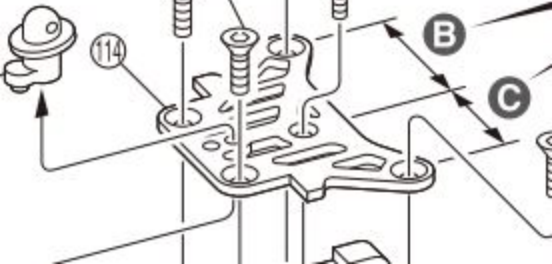

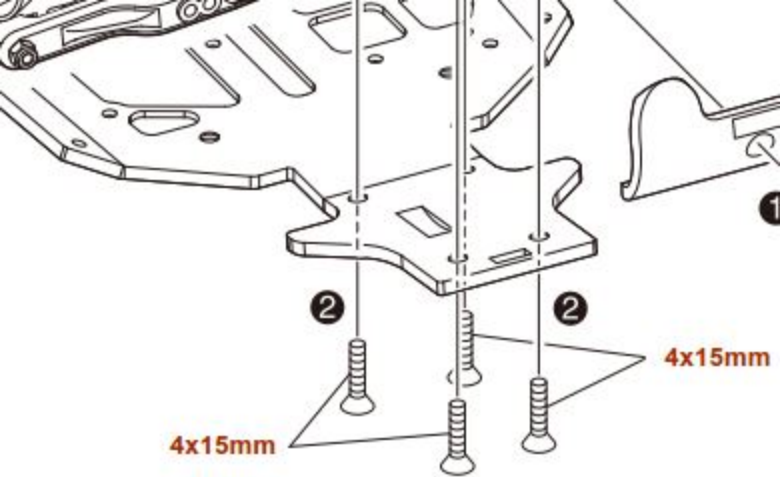

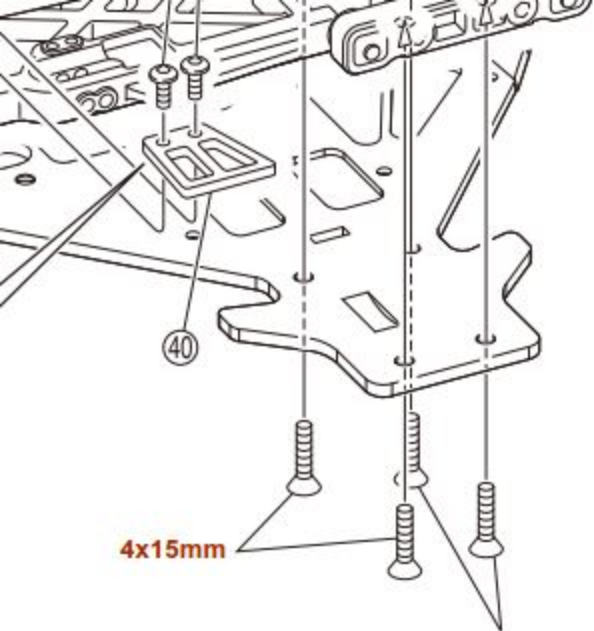

40

4x15mm

4x15mm

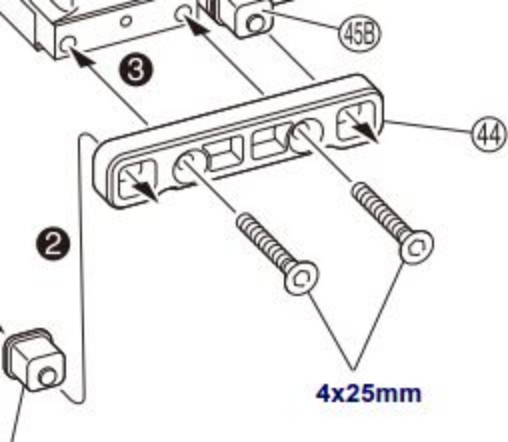

**3x6mm**

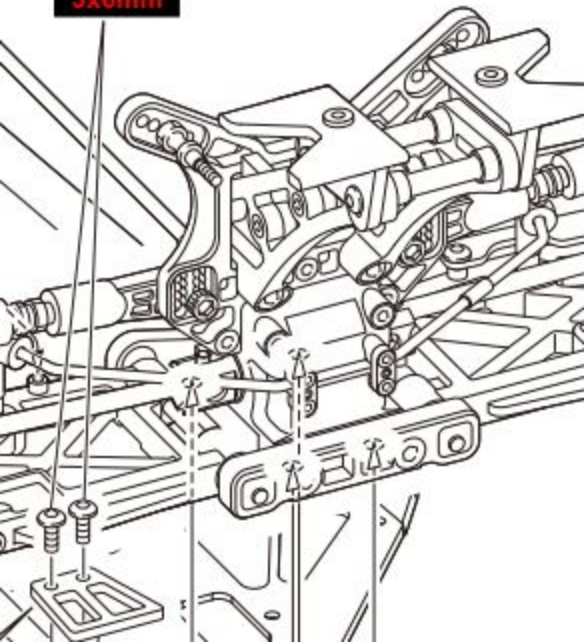

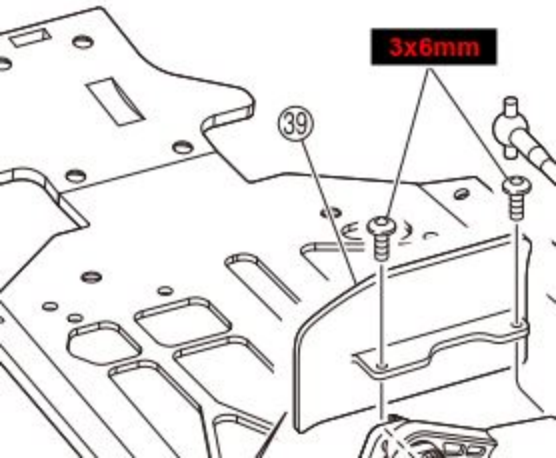



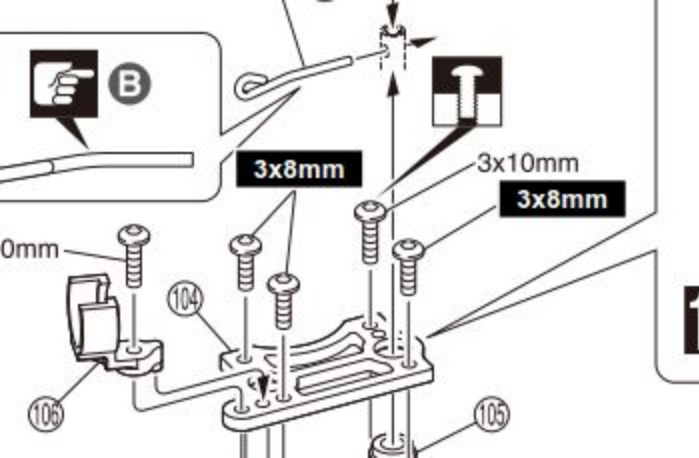

3x8mm

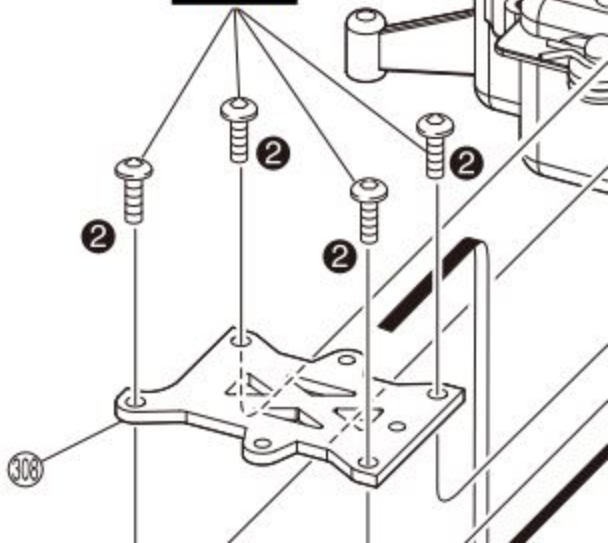

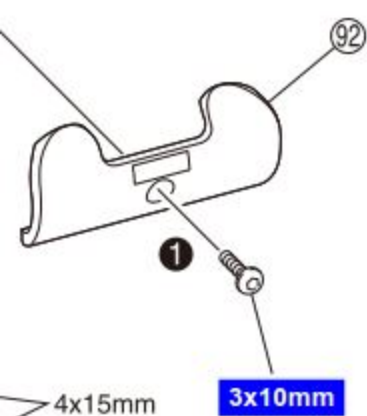

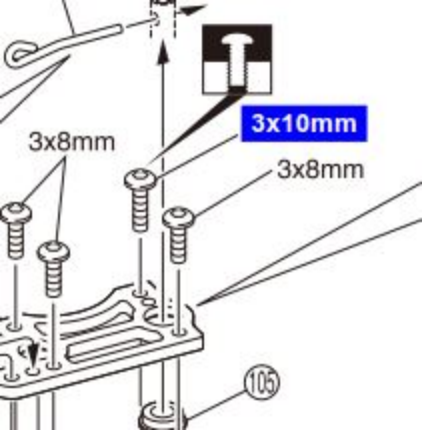

..... 2

クスビス  
ex Screw

..... 3

クスビス  
ex Screw

..... 2

ト

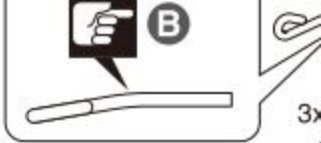

**3x10mm**

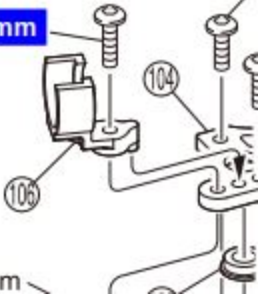

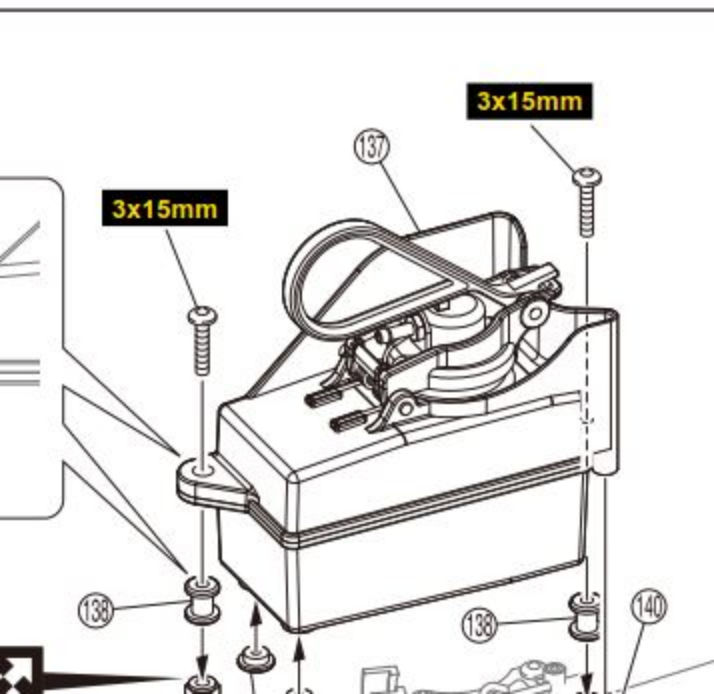

**3x15mm**

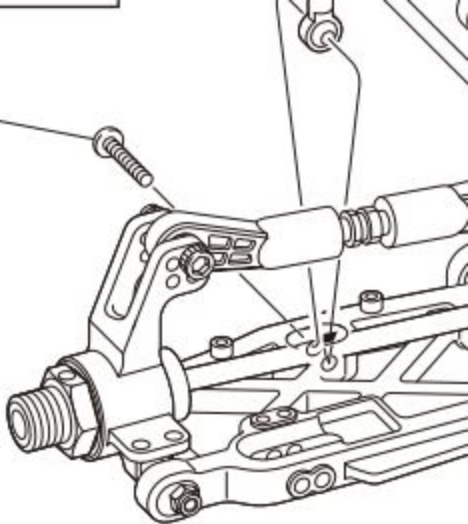

No.6, 8



ボ  
rvo



3x15mm

3x15mm

3x15mm

3x15mm

3

3

3

3

ステア  
Steer



A 159

A 159

159 A

159 A

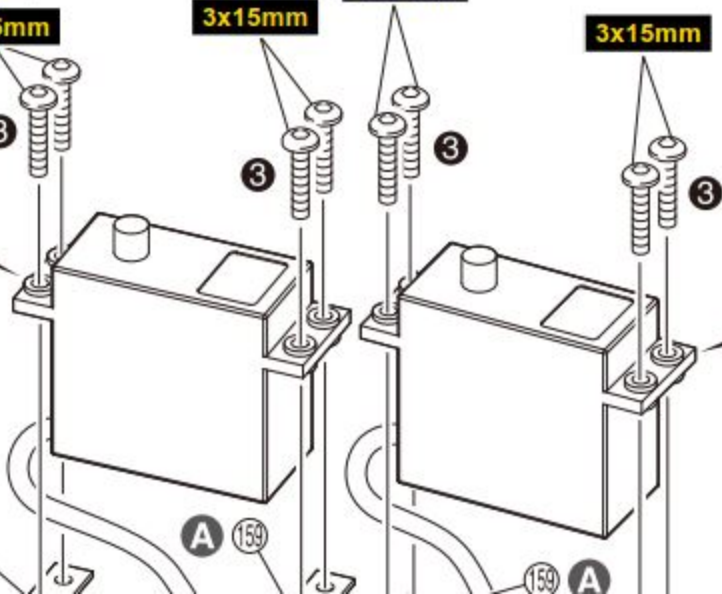



3x18m

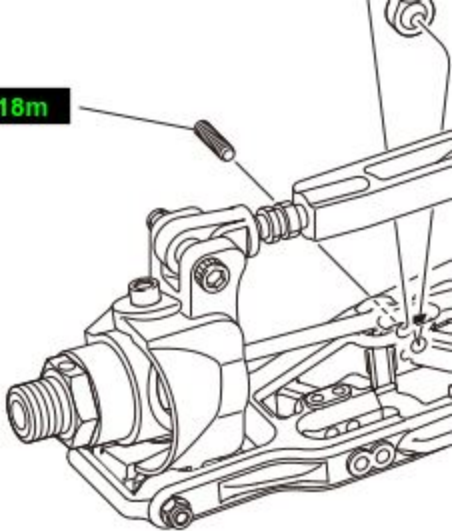

4x8mm

